

TargetLink

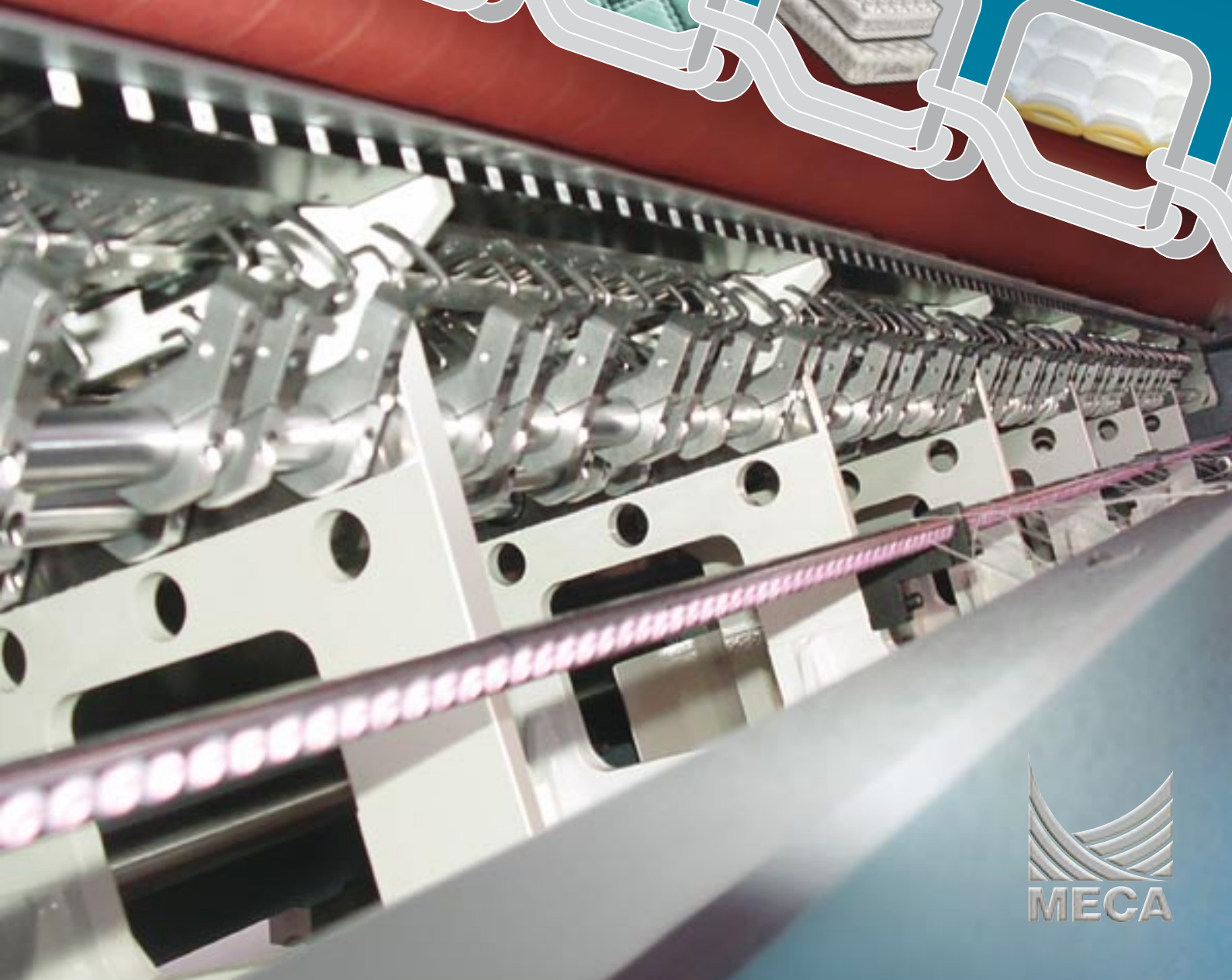

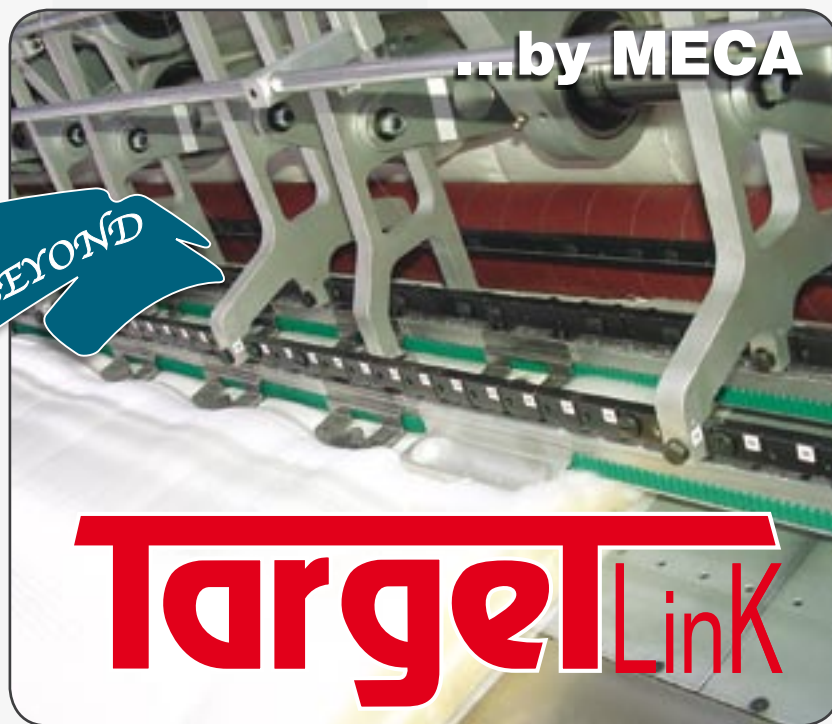

a global performance in mattresses Quilters

Unique and innovative highspeed multineedle double-chainstitch quilter with dedicated interchangeable **PRESSER ROBOT FEET**

This innovation allows the operator freedom to express his full creative potential through the easy setting of interchangeable feet for the execution of all standard, 360° pattern range and cording programs. Furthermore without presser plate many additional advantages:

- **PRESSER FEET ONLY CORRESPONDING TO ANY NEEDLE SET**
- **VERY TIGHT STITCHES**
- **MORE DWG PRECISION**
- **MORE QUILTING THICKNESS UP TO 3" AND PUFF EFFECTS**
- **MORE VISIBILITY**

These machines are suitable for quilting light, extra heavy and thick materials such as **mattress panel, bedspread, quilt, comforter, sleeping bag, upholstery, mattress border** and **components for home furnishing**.

Any actual and innovative article can be decorated with cording, high-fashion designs capable to capture the consumer's attention providing a marketing advantage.

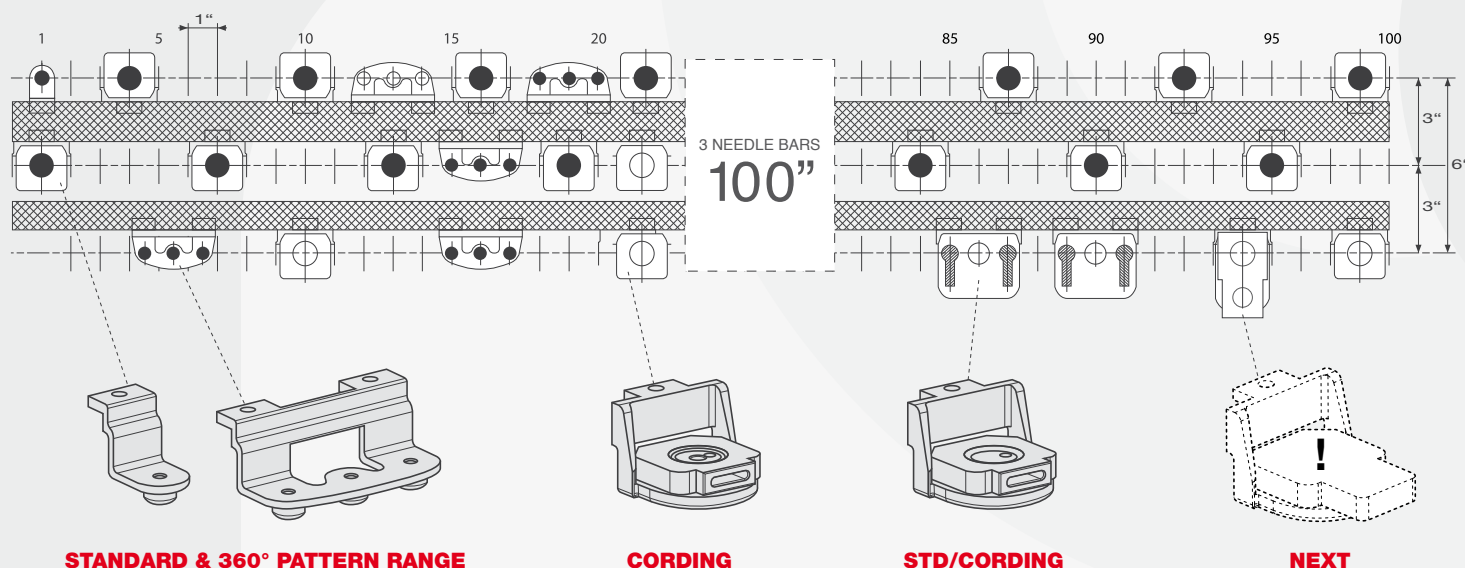

STANDARD / 360° PATTERN RANGE with 1 and 3 feet position

Combining the presser feet position using whatever needle set on one, two or three needle bars it permits the whole STANDARD QUILTING PROGRAM and the whole 360° PATTERN RANGE PROGRAM.

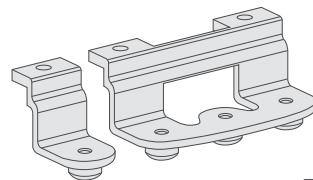

Pat.

CORDING PROGRAM with cord robot feet

Combining the cord robot feet using whatever needle set either on one, two or three needle bars it permits the whole CORDING PROGRAM.

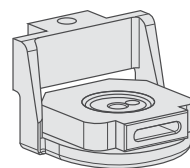

Pat.

NEXT

The patented "TRANSPower" system is projected to receive other robot feet to execute further programs possibly to be developed in the future ONLY by **MECA**.

NEXT !



Exclusive mattress border with any cording logo.



High-Speed Multi-Needle Double Chainstitch Quilting Machines

TargetLink

This machine revolutionises the industry by combining standard quilting, 360° intricate decorative patterns and cording technologies into one high productive and efficient sewing system capable to perform unique and exclusive programs with **MAXIMA** flexibility.

TargetLink available in STD / 360° model without cording.

STD / 360°

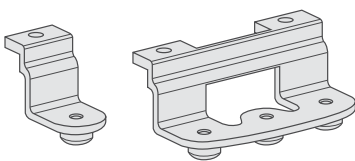

Pattern range



Target Link is the most advanced three-bar multineedle chainstitch quilting machine in the world complete with fully integrate computerized control system “Pegasus”. The Target Link features with exclusive presser robot feet permit the execution of unique quilting programs.

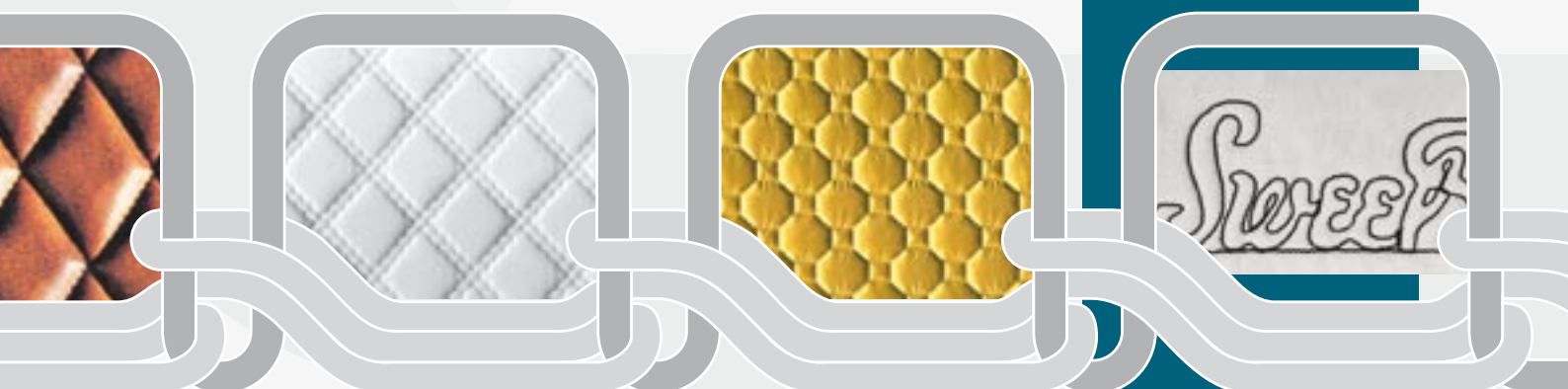

TargetLink



100"

Needles Position	Needle Rows	Working Width	Carriage Stroke	Cording Feet	Standard Feet		Stitch Length	Working Speed
100 x 3 1" Pitch	3 3"-6"	cm. 250 (100") + cm. 30 (12")	mm. 305 12"	34	64 1"	15 3"	1÷6 mm	Up-to 1100 spm

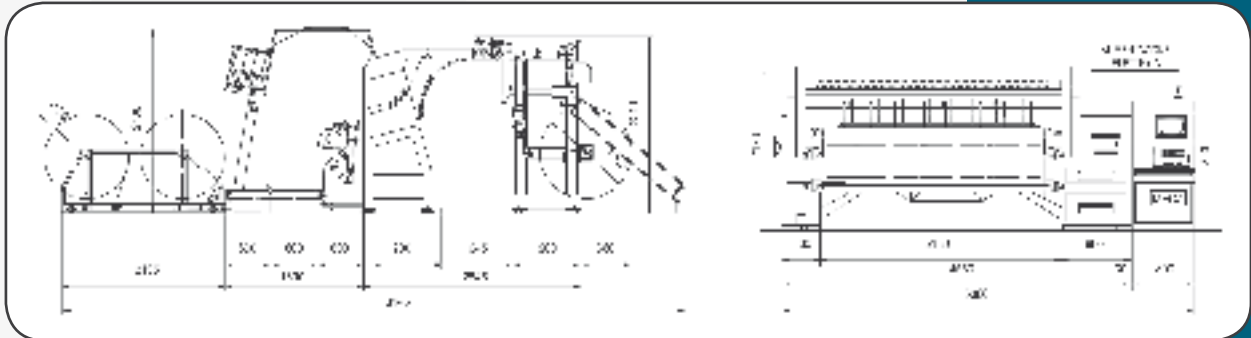

TargetLink available also in 120" model



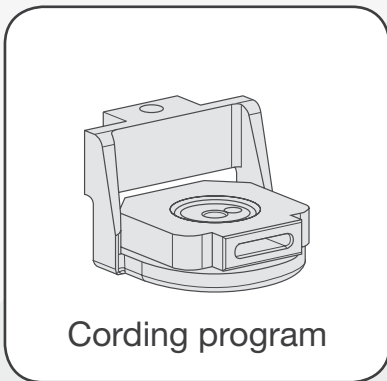
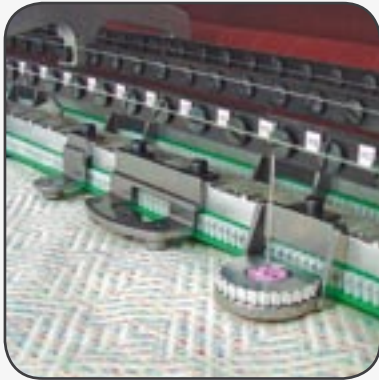
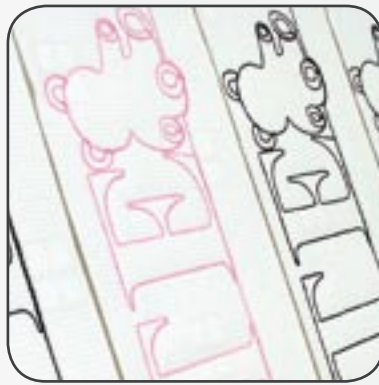
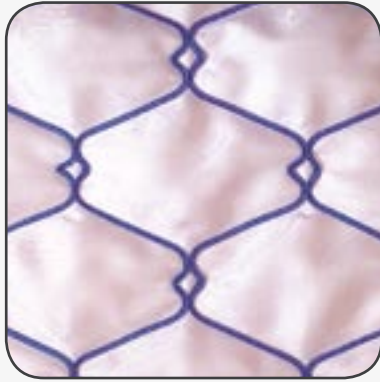

Cording program



Exclusive mattress border with any cording logo

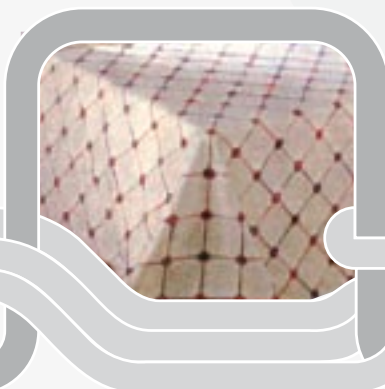

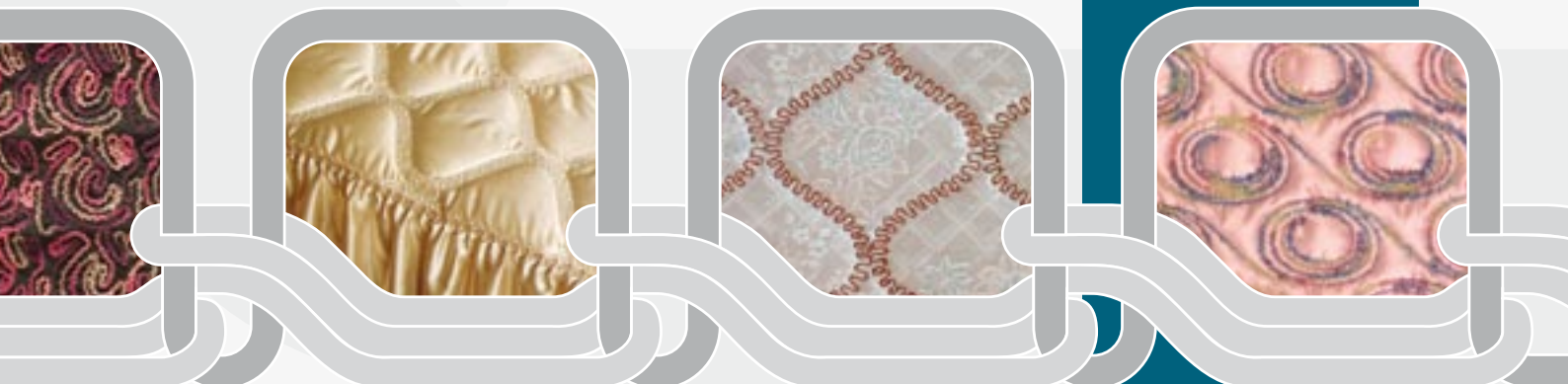
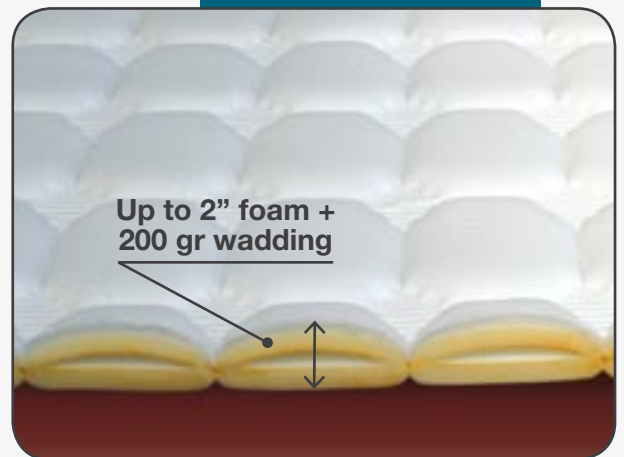
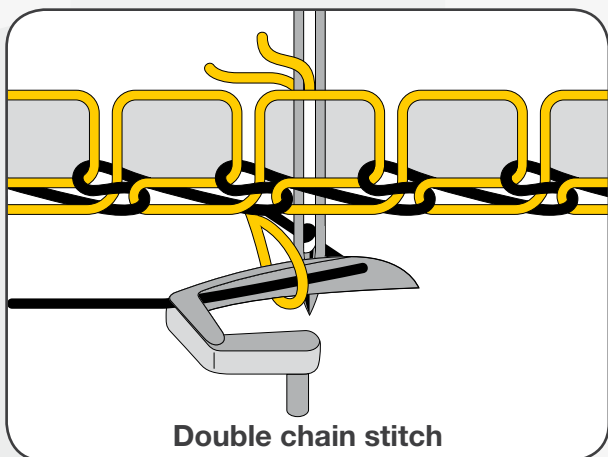

TargetLink



Customer care
Diagnostic & logs
User friendly
Drawing editor
Flexibility
Statistic



PEGASUS is the new MECA software able to make the communication through user and machine easier and to reduce maintenance rate.

For the automation of its full range of quilting machines, MECA chose a solution based on the use of 2 industrial PCs: one exclusively provides for the real control of the axis, the other, through the winning graphic interface, allows the user to easily and fully control the machine and even the remote assistance and the hardware and software diagnostic.



The diagnostic keeps under control the functioning of the power drives and motors installed on the machine, providing the creation of a serie of record files containing the operating machine data. To manage any eventual hardware and software problem, the system records all the operations performed by the quilting machine so that, during the maintenance, technicians are exactly informed about what happened. The PCs also create a serie of statistic files and reports that can be integrated into the Customer's operating software.

Thanks to the machine on-line connection, the person in charge of the production or the commercial foreman can carry out inquiries about one or more quilting machines to get the production data, finding out eventual gaps in the productive cycle or checking, i.e., the higher or lower performance of the machine in relation to certain productions. On the whole a full range of statistic data to be examined directly from the office with no need to go next to the machine to get the information.

For a Company like Meca, Leader in this field, exporting in more than 74 countries all over the world, it is essential to have a remote assistance service to reduce to the minimum the maintenance wait. For this reason, the equipment of the MECA quilting machines includes a software that, by means of an internet connection, permits to the Customer to enter the portal of the technical maintenance. From this portal, through a dedicated server, the connection to the PC that controls the quilting machine is assigned to the computer of the technician responsible for the maintenance. From now on the technician has the full control of the quilting machine installed by the Customer, so as the possibility to enter the software functions and even the operating system.

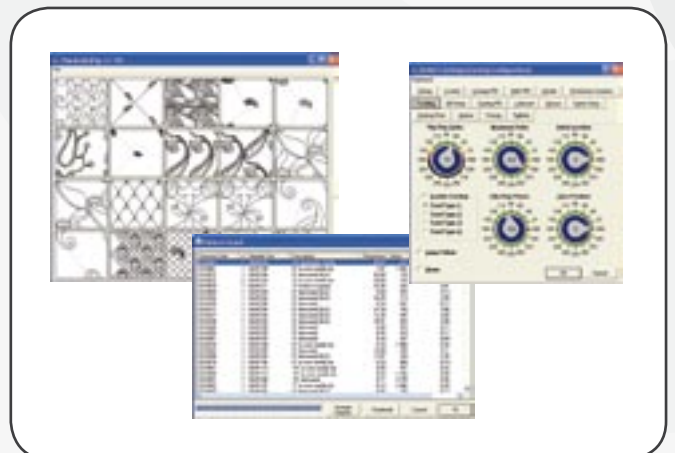

Creative Software



NEW APPROACH:

use of images imported from scanners, vector graphic tools or most used graphic software.



EASY WITH THE SMILE PARAMETERS:

helpful features like the in-line help, parameters preview and the SMILE icon that shows the parameters correctness.

POWERFUL AND CREATIVE:

high precision calculation, 300 in-line special stitches and 100 expandable special stitches that can be adapted to any shape.

ADVANCE PUNCHING:

- automatic filling contour recognition
- automatic object recognition from vector images
- 5 different source lines node types
- automatic, semi-automatic and manual contour definition

IN-LINE EDITING:

moving, scaling and rotating any single design object during or after the design creation.

Drag and drop features enabling to move objects and parameters just with a simple mouse click.

TRUE VIEW:

simulation function to preview the design effects and the quilted result.



OPTIONAL

- CROSS CUTTING
- EDGES TRIMMER
- MULTI CUTTING HEADS
- STILISTA 2000
- STOP MOTION FOR NEEDLE AND HOOKS



www.meca.it



MECA S.p.A.

S.da Prov.le Busto/Cassano n° 3
21054 Fagnano Olona (VA) - Italy
P.O. Box 60

tel. +39 0331 685605 - fax +39 0331 686340 / 686279
info@meca.it